

Tour of the historical city centre - Alter Markt, Landtag and Alte Fahrt

Dates: May - October, every Sunday, Duration: 1.5 hours.
Meeting point: 11am in front of Tourist-Information Centre Am Alten Markt.
Price: 8.00 €/ person, tickets available at Tourist-Information Centre Am Alten Markt, Am Luisenplatz, and Potsdam Central Train Station and under www.reservix.de, group or special tours by arrangement.
Contact: Potsdam Marketing und Service GmbH
Humboldtstr. 1-2, 14467 Potsdam, phone: +49 331 27 55 88 99
Email: gruppen@potsdamtourismus.de, www.potsdamtourismus.de

Panoramic View from St. Nicolas Church

From the colonnaded roof of St. Nicolas Church, you see the new Landtag and take in one of the most spectacular views in the capital city of Potsdam. The classicist church was built based on the plans of Karl Friedrich Schinkel and is a monument of national importance. Open from Nov - Mar 10am - 5pm, Apr - Oct 10am - 7pm.
Admission to tower: 5 €, phone +49 331 270 86 02,
email: info@nikolaipotsdam.de, www.nikolaipotsdam.de

The Exhibition "Land und Leute"

Geschichten aus Brandenburg-Preußen" (Country and People – Stories from Brandenburg-Prussia) presents the eventful history of the City Palace in pictures and films. An interactive city model explains Potsdam's role as a residence of the Prussian military monarchy and presents Potsdam's building development in 1912.
Kutschstall, Am Neuen Markt 9, phone: +49 331 62085-50, www.hbpg.de
Admission to permanent exhibition 4.50 €, 3.50 € (red.) Opening hours: Tue - Thu 10am - 5pm, Fri - Sun and public holidays 10am - 6pm,

Experiencing the City's History

Are you curious about the history and stories of our city? Then visit the permanent exhibition "Potsdam. Eine Stadt macht Geschichte" ("Potsdam. A City Makes History") and the special exhibitions on the city's art and cultural history as well as various events. Potsdam Museum – Forum für Kunst und Geschichte, Am Alten Markt 9, phone +49 331 289 6868,
Opening hours: Tue/Wed/Fri 10am - 5pm, Thu 10am - 7pm,
Sat/Sun 10am - 6pm, www.potsdam.de/potsdam-museum

MuseumsKombikarte (Museum Combination Ticket)

10,000 exhibited objects, 4 museums, 1 ticket; available at the Filmmuseum Potsdam, Museum of Natural Science, House of the Brandenburg-Prussian History (HBPG), Potsdam Museum as well as at the Potsdam Tourist Information Centre, 12 € for one adult and up to two children.



Editor: State Capital of Potsdam (LHP)
The Mayor's Office
Marketing Department
Friedrich-Ebert-Straße 79/81, 14469 Potsdam
phone: +49 331 289 1270, fax: +49 331 289 3310
email: marketing@rathaus.potsdam.de, www.potsdam.de

In cooperation with: Sanierungsträger Potsdam GmbH (STP) and the corporate network PRO POTSDAM, Pappelallee 4, 14469 Potsdam
phone: +49 331 6206 777, fax: 0331-6206 737
email: potsdamer-mitte@propotsdam.de, www.potsdamer-mitte.de
Design: Andreas Stadler (A-ST)
Print: Druck- und Medienhaus Hans Gieselmann
Editorial deadline: 15 December 2016
Print run: 20,000 (This flyer is also available in German)
© December 2016

Background photo: Standing wrestler, former colonnade between Royal Stables and City Palace (SPSG)
Cover photo: View from Freundschaftsinsel towards Alter Markt Square, November 2016 (A-ST)

Development of the University of Applied Sciences Complex

The face of Alter Markt has changed tremendously in recent years: Potsdam's largest and most impressive church – St. Nicolas – has been refurbished. The Old Town Hall and the Knobelsdorff Building have been converted into the Potsdam Museum. Upon the completion of the new Brandenburg parliament building, democracy moved into Potsdam's centre. The first buildings at the Havel riverfront and at Otto Braun Platz were completed in summer 2015. Another magnet for visitors will be the Museum Barberini, which will be opening its doors in January 2017.

All of the development around Alter Markt is based on the Landmark Buildings Concept of 2010. The concept, which focuses on approaching the city's historical layout, has been continuously refined. This process demands the consideration and integration of various social and political aims and opinions.

The development of the so-called Blocks III and IV, another stage of the Landmark Building Concept, on the premises of the University of Applied Sciences will begin in the first quarter of 2017.

In the bidding process, we are looking for designs that combine high architectural standards with convincing utilisation concepts. The new buildings should particularly provide housing. Concepts including rent control options will receive a higher rating in the selection process, thus securing affordable housing in Potsdam's city centre.

The southern Block III will consist of 14 new buildings and the northern Block IV of 15. Keeping in mind design elements typical of the city centre, 23 out of the 29 buildings will feature contemporary architecture with a particular emphasis on corner buildings. Three of them will have structural elements reminiscent of their predecessors albeit with a contemporary appearance. Another three buildings will boast the façades of their historical predecessors.

The two blocks will be developed in stages. Once the construction and utilisation concepts have been completed for Block III, the bidding process for Block IV will begin. The southern part of the teacher training college from the early 1970s – currently being used by the University of Applied Sciences – will first have to be demolished. The Potsdam University of Applied Sciences will have completely moved to its new location at Bornstedter Feld by the end of 2017.

The northern section was converted into the present Education Forum in 2014. Various academic institutions of the state capital are also based at this central location – the City and State Library, the adult educational centre, and the Science Floor.

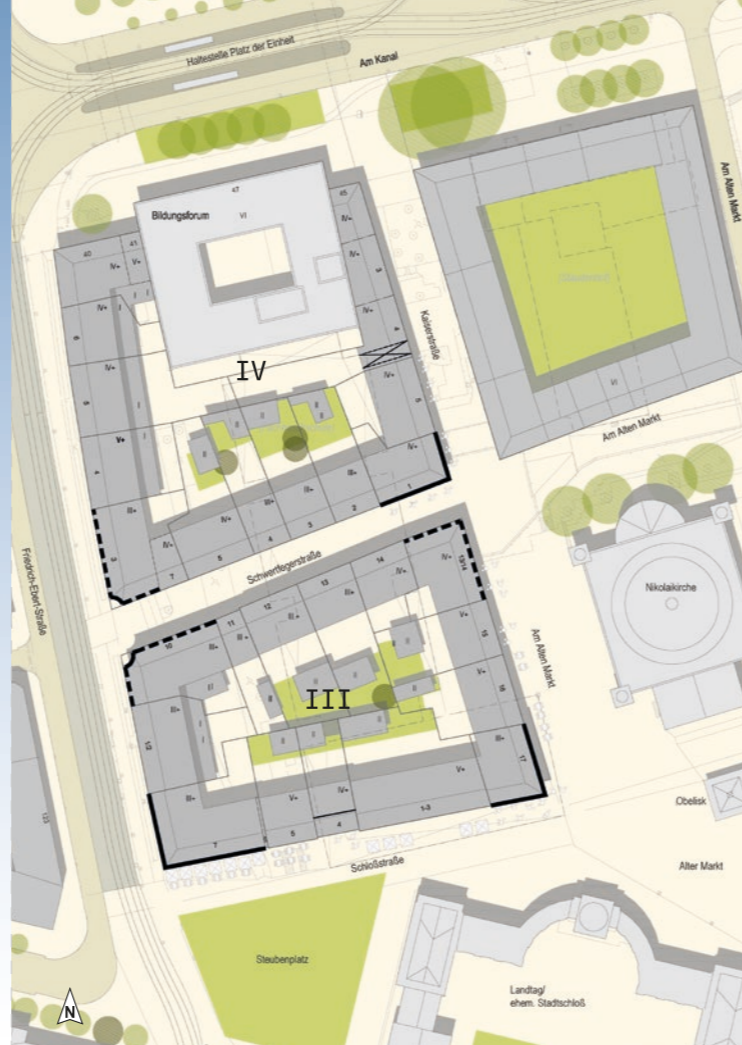

Site map urban planning design, block design, Blocks III and IV

- Planned building, conceptual design (with desing guidelines/ landmark façade)
- Existing building
- Planned building or under construction (surrounding areas)
- Existing building to be demolished (with designation)
- Conceptual design of property lines (Blocks III and IV)
- Green space
- Other open space (with street furniture) mixed traffic area
- Existing and planned trees
- Streetscape
- Tram stop
- Existing pedestrian crossing
- Tram line/ separate

100 m
(design: Planergemeinschaft; ProStadt GmbH; architect Bernd Redlich)

The New Development "Zum Einsiedler"

In May 2016, a selection committee of politicians, administrators, and experts chose the winning design from seven qualified bids for the development of the premises of Zum Einsiedler (hermit's house) on the corner of Schloßstraße and Friedrich-Ebert-Straße. Based on the Landmark Buildings Concept of 2010, new tenders were invited in 2015. A suitable buyer was not found in 2010.

The design of the buildings at Schloßstraße will allude to their historical predecessors. A triangular pediment will be used as a distinct element to reinterpret the historical cityscape and will evoke the former Zum Einsiedler building. A separate, modern building will be erected at Friedrich-Ebert-Straße.

Business and service facilities as well as housing are featured in both buildings. The successful combination of interpreting historical building elements in a modern way and contemporary architecture will re-establish a part of the city's historical centre at this location.



Competition results: Façade on Friedrich-Ebert-Straße (design: Dietz Joppien Architekten)



Competition results: Visualization on the corner of Schloßstraße (Dietz Joppien Architekten)

Colonnade Ringerkolonnade at the Square Steubenplatz

The rebuilding of the Ringerkolonnade at Steubenplatz completed the transformation of the public places around the Landtag parliament building. The squares Alter Markt, Otto Braun Platz, and Steubenplatz along with the Ringerkolonnade have become key public areas in Potsdam's centre. The Ringerkolonnade's return to its historical location in April 2016 was duly celebrated – children, youth, and adult athletes from the wrestling club Ringerclub Germania Potsdam e.V. filled the colonnades with life. Where cars once raced across the bridge Lange Brücke towards the city centre, pedestrians and cyclists now take priority.

The transparent architecture of the Ringerkolonnade between the Royal Stables and the City Palace once formed the border between the royal pleasure garden Lustgarten and the bourgeois town before being partially destroyed in 1945 but without obstructing the view. Parts of the colonnade could be saved in 1959/60 when the City Palace was demolished. In 1970, they were restored, primarily with original pieces from the car park of the Interhotel and a sculpture garden at the car park of the inner harbour.

When the Neuer Lustgarten was redesigned for the 2001 National Garden Show, the colonnade stood next to the Neptune Fountain that had been restored in 2000. The structural condition of the Ringerkolonnade had long been problematic, compromising its stability.

The Ringerkolonnade at Lustgarten was dismantled in autumn 2015 and inspected for damages. After refurbishing the colonnade's stone with conservational methods, the row of columns was partly supplemented by new column bases and drums and reassembled on new bases. Unfortunately, the sculptures of wrestlers that gave the colonnade its name as well as vases and putti have not yet been able to be re-erected. They are still waiting for a stone-conserving restoration that will be privately funded.



Ringerkolonnade (photo: A. Stiebitz/STP)

Potsdam City Centre



2017



Dear Citizens of Potsdam, Dear Guests and Visitors,

This is the 10th edition of our flyer on Potsdam's city centre. Comparing the 2008 edition with the current one shows how much Potsdam's centre has changed over the past 10 years. The new Landtag parliament building, the new buildings at the Havel riverfront with Palace Barberini, the newly designed square Otto Braun Platz, and the waterfront promenade on Alter Fahrt all invite you to linger. The Educational Forum, St. Nicolas Church, Brocksche Palais as well as Potsdam Museum in the Old Town Hall with the Knobelsdorff Building have all been renovated. After more than 40 years, the colonnade Ringerkolonnade has returned to its original location between the Royal Stables and the City Palace. Public and private investment has reshaped the city's image. Every year, citizens as well as visitors from near and far are increasingly interested in the city's development. This reaffirms that we have set the right course for reconstructing and redesigning Potsdam's city centre.

And the development continues. Ideas for redesigning the Plantation were developed together with children and young people. Construction commences in 2017. By 2020, once Brandenburg's Data Processing Centre has moved out and the so-called "computer hall" has been demolished, the long-neglected public green space will be adequately upgraded. By the end of 2017, the remaining departments of the University of Applied Sciences will have moved to their new location at Bornstedter Feld, and the university building at Alter Markt will be demolished. On the basis of the Landmark Buildings Concept, we will be looking for designs that tie in with the qualities of the historical urban structure at this location. This is not about building replicas. The architecture of all buildings – aside from three that will have historical façades – will be contemporary. When allocating the properties, we demand a high standard of architectural design. We also attach great importance to a diverse range of services as well as creating affordable housing to ensure an inviting and lively neighbourhood.

Museum Barberini

The Museum Barberini will open with two exhibitions and present its collection "Impressionism: The Art of Landscape" (23 Jan. – 28 May 2017), which brings major Impressionist works by artists such as Claude Monet, Gustave Caillebotte, and others to Potsdam. The exhibition "Modern Art Classics: Liebermann, Munch, Nolde, Kandinsky" (23 Jan. – 28 May 2017) spans from German Impressionism to post-1945 abstract art, including works by Max Liebermann and Gerhard Richter. In two gallery rooms, the Museum Barberini will also be presenting "Art from the GDR" from the museum's collection.

In cooperation with the Phillips Collection, Washington, D.C., the museum will be presenting "From Hopper to Rothko: America's Road to Modern Art" (17 Jun. – 3 Oct. 2017), which focuses on the history of 20th-century American art. In autumn/winter, the exhibition "Behind the Mask: Artists in the GDR" (28 Oct. 2017 – 11 Feb. 2018) explores artistic self-portrayals from 1949-1989. The exhibitions are accompanied by readings, lectures, and discussions. You can find current events at www.museum-barberini.com

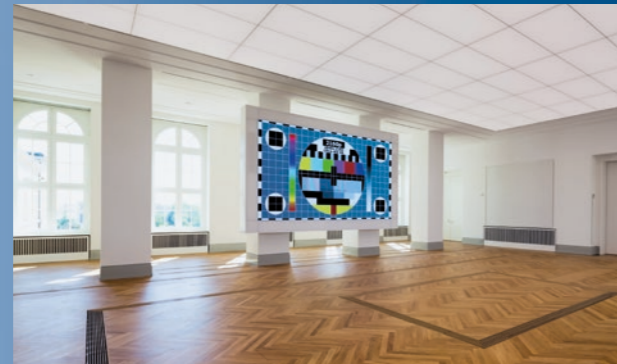

Event room with media wall (photo: Museum Barberini)

Foyer (photo: Helge Mundt)



Construction Schedule Starting 2017

- Redevelopment of northern part of Plantation (1st stage) ①
- Building construction on Brauerstraße ②
- Demolition of University of Applied Sciences complex ③
- Adjustment of bicycle path Lange Brücke/Humboldtstraße ④
- Construction of Garrison Church tower ⑤

Starting 2018

- Completion of demolition of University complex ③
- Demolition of Computer Hall of the Data Processing Centre ⑥

- Completion of redeveloped northern part of Plantation ①
- Construction of building at Fr.-Ebert-Str. 123 and "Zum Einsiedler" ⑦

Starting 2019

- Redevelopment of the Plantation (2nd stage of construction) ①
- Rearrangement of University of Applied Sciences complex ⑧
- Reconstruction of former Schwertfegerstraße and Kaiserstraße ⑨
- Redesigning of "Gartenplatz" (passage to green space at the river) ⑩

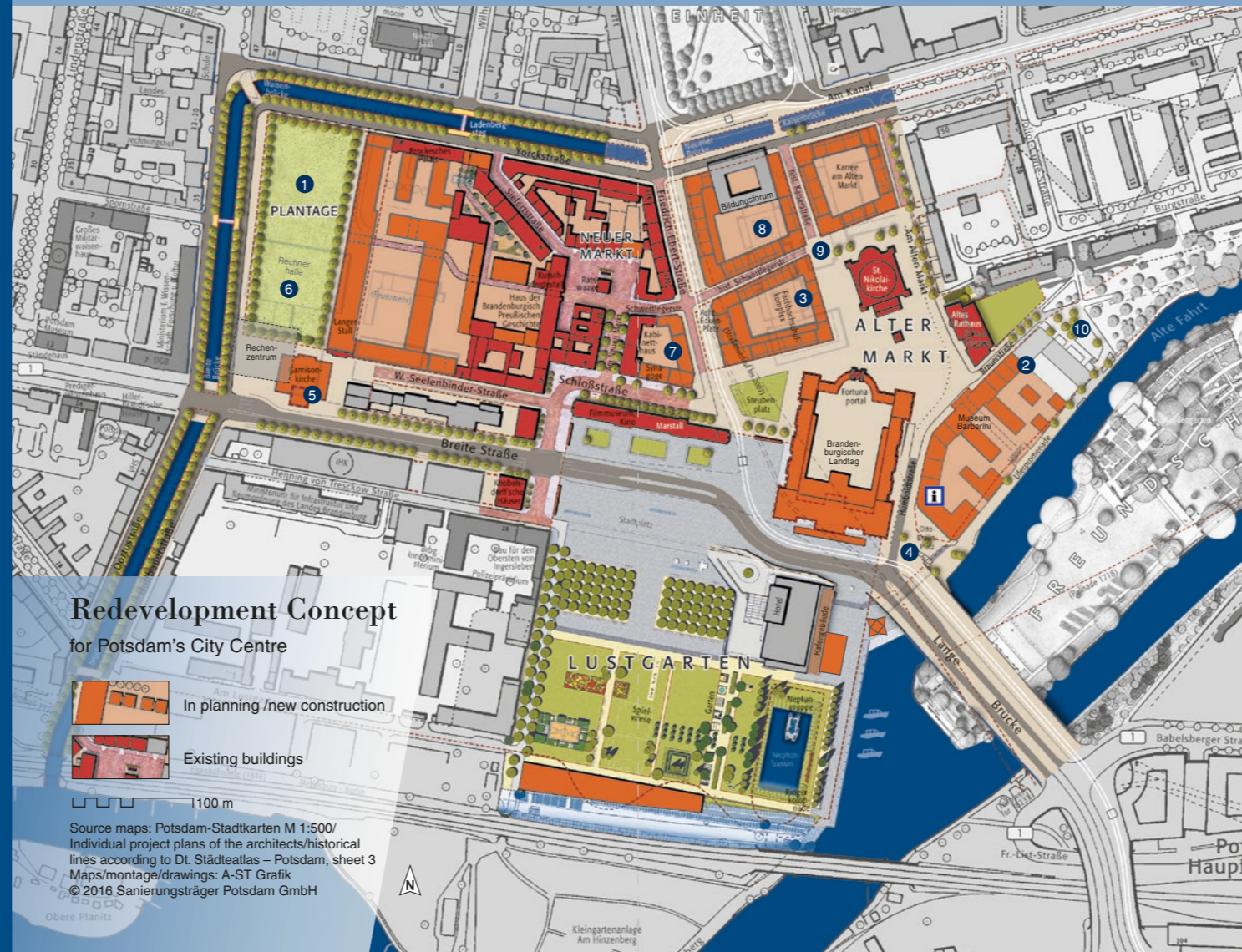

Redevelopment of the Plantation

The Plantation is one of Potsdam's largest city squares. Its once-swampy grounds remained undeveloped for a long time. In the 18th century, it was integrated into the city's structure as a public green space. Around 1850, Lenné's design made the Plantation a decorative square. After the Data Processing Centre was built in the 1970s, buildings covered about half of the park, drastically reducing the amount of public space.

A landscape redevelopment competition for the Plantation was launched in summer 2016. The planning offices had to present a contemporary design for the northern part of the Plantation as well as make innovative suggestions for the southern part with the extant Data Processing Centre. The winning design from the architectural office of hutterreimann (Berlin) was titled "Drei Rahmen und viel drin". The design follows Peter Joseph Lenné's idea of linden trees framing green space.

A circular track through the park, which will be partly lined with long concrete benches with ergonomically shaped backs, will provide opportunities to be active or to take a stroll. A "Small Plantation" will be laid out along the buildings planned for the Langer Stall site. On a slightly inclined meadow, shrubs and various trees will offer a cheerful garden atmosphere with a variety of seasonal blossoms, fruit, and leaves.



Parts of a pre-cast concrete wall from the 1970s will be integrated into a children's area with playhouses, a tube slide, and a jungle gym. An abacus will allude to the Data Processing Centre's history.

Various needs have to be reconciled with a representative design for an inner city green space. Facilities for playing, doing sports, and exercising will be available not only to children from the Max Dortu Primary School but also to visitors. The design for a mini pitch will be modestly marked, the northern part of the sandy play area used as a long-jump pit, and the track for 100m sprints or endurance runs.

The conversion will take place in several phases: The redesigning of the northern part of the square begins in summer 2017. The realization of the southern part is currently planned for 2019, once the computer hall of the Data Processing Centre has been demolished.

Depending on the structural development on the premises of the Data Processing Centre, additional changes will take place up to Breite Straße.



Children and young people expressed their ideas and wishes during workshops in preparation for the competition. During the construction phase, we plan to have a "children's construction site". (photos: Gruppe F/STP)



Jann Jakobs
Mayor of Potsdam

