

## Guided Tour of the Historical City Centre – Alter Markt, Landtag and Alte Fahrt

Group tours can be booked individually on request. Price: 115€/group (max. 15 participants). Duration: 1.5 hours. Booking and information: Group service of PMSG Potsdam Marketing and Service GmbH, Babelsberger Strasse 26, 14473 Potsdam. Phone: +49 331 27558 50, Email: gruppen@potsdamtourismus.de, www.potsdamtourismus.de

## Experiencing the City's History, Discovering Satirical Sculptures, Painting, and Photography

Are you curious about the history and stories of our city? Then visit the permanent exhibition "Potsdam. Eine Stadt macht Geschichte" ("Potsdam. A City Makes History") at Potsdam Museum, admission free. The special exhibitions cover a great variety of topics: At the beginning of the year you can look forward to inimitable and ambiguous sculptures by Rainer Sperl. For a somewhat different exhibition in the second half of 2021, Potsdam residents have chosen their favourite works from the collection of the Potsdam Museum. Admission to special exhibitions: 5€, 3€ (red.). Potsdam Museum – Forum für Kunst und Geschichte, Am Alten Markt 9, 14467 Potsdam. Opening hours: Tue-Sun 10am-6pm, Phone +49 331 289 68 68, www.potsdam-museum.de and www.facebook.com/PotsdamMuseum

## Panoramic View from St. Nicholas Church

From the colonnaded roof of St. Nicholas Church, you can see the Landtag, Museum Barberini, and Alter Markt and take in one of the most spectacular views of the capital city of Potsdam. The classicist church was built according to the plans of Karl Friedrich Schinkel and is a monument of national importance. Opening hours: Daily 10am-6pm, longer opening hours in summer, Sun from 11:30am. Admission to tower: 5€. Phone +49 331 270 86 02, Email: info@nikolaipotsdam.de

## International Art and Potsdam's History

At Museum Barberini, you can marvel not only at international art exhibitions but also enjoy guided tours about the history of the place. Special tours about the architecture and history of the building are available anytime upon request. A big Smart Wall in the museum presents historical background information. Museum Barberini, Humboldtstrasse 5-6, 14467 Potsdam. Opening hours: Mon and Wed-Sun 10am-7pm, every first Thursday of the month 10am-9pm. Admission: 14€, 10€ (red.), free admission for children and teens under 18 years. Phone: +49 331 236014 499, www.museum-barberini.com

## Museums-Kombikarte (Museum Combination Ticket)

10,000 exhibited objects, 4 museums, 1 ticket: available at Potsdam Museum, Filmmuseum Potsdam, Natural History Museum Potsdam, House of Brandenburg-Prussian History (HBPG) and at the Potsdam Tourist Information Centres. Price: 12€ for one adult and up to two children.

Published by: Landeshauptstadt Potsdam  
The Mayor's Office, Marketing Department  
Friedrich-Ebert-Strasse 79/81, 14469 Potsdam  
Phone: +49 331 289 1270, Fax: +49 331 289 3310  
marketing@rathaus.potsdam.de, www.potsdam.de

In cooperation with Sanierungsträger Potsdam GmbH, a company of the corporate network ProPotsdam, Pappelallee 4, 14469 Potsdam, Phone +49 331 6206 777, Fax: +49 331 6206 737  
potsdamer-mitte@propotsdam.de, www.potsdamer-mitte.de  
Design: A. Stadler, Print: Brandenburgische Universitätsdruckerei  
Editorial deadline: 19 December 2020, Print run: 24,000  
© January 2021 (This flyer is also available in German.)

Background photo: "Standing Wrestlers", former colonnade between royal Stables and City Palace (SPSG)  
Cover photo: Aerial photo of Potsdam city centre, looking westward 04/2020 (Falcon Crest)

## Archaeology – The Ancient Potsdam People

With the detailed archaeological investigation of the historical centre of Potsdam in recent years, the excavations carried out as part of the road construction west of St. Nicholas Church unearthed new findings. Medieval streets and the remains of an old churchyard where people were buried until 1720 were discovered beneath the historic pavement around St. Nicholas Church. In 1600, the city built a cemetery wall and even allowed houses to be built on the churchyard. Only after King Frederick William I ordered the construction of the Baroque church, did burials in the churchyard come to an end.

The uncovering of over 40 graves made it possible to get very close again to the "ancient Potsdam people". Some of the skeletons from the 13th - 17th century showed deviations from the usual burial rites as well as severe injuries. Some were buried lying on their stomachs or sides to make it more difficult to rise from the grave. This was done due to medieval and early modern superstitions about revenants or vampires.



This young man was buried lying on his stomach in the 14th century. Presumably, the people were afraid that he might reappear as a revenant. (photos: Archäologie Manufaktur)



Historical pavement west of St. Nicholas Church

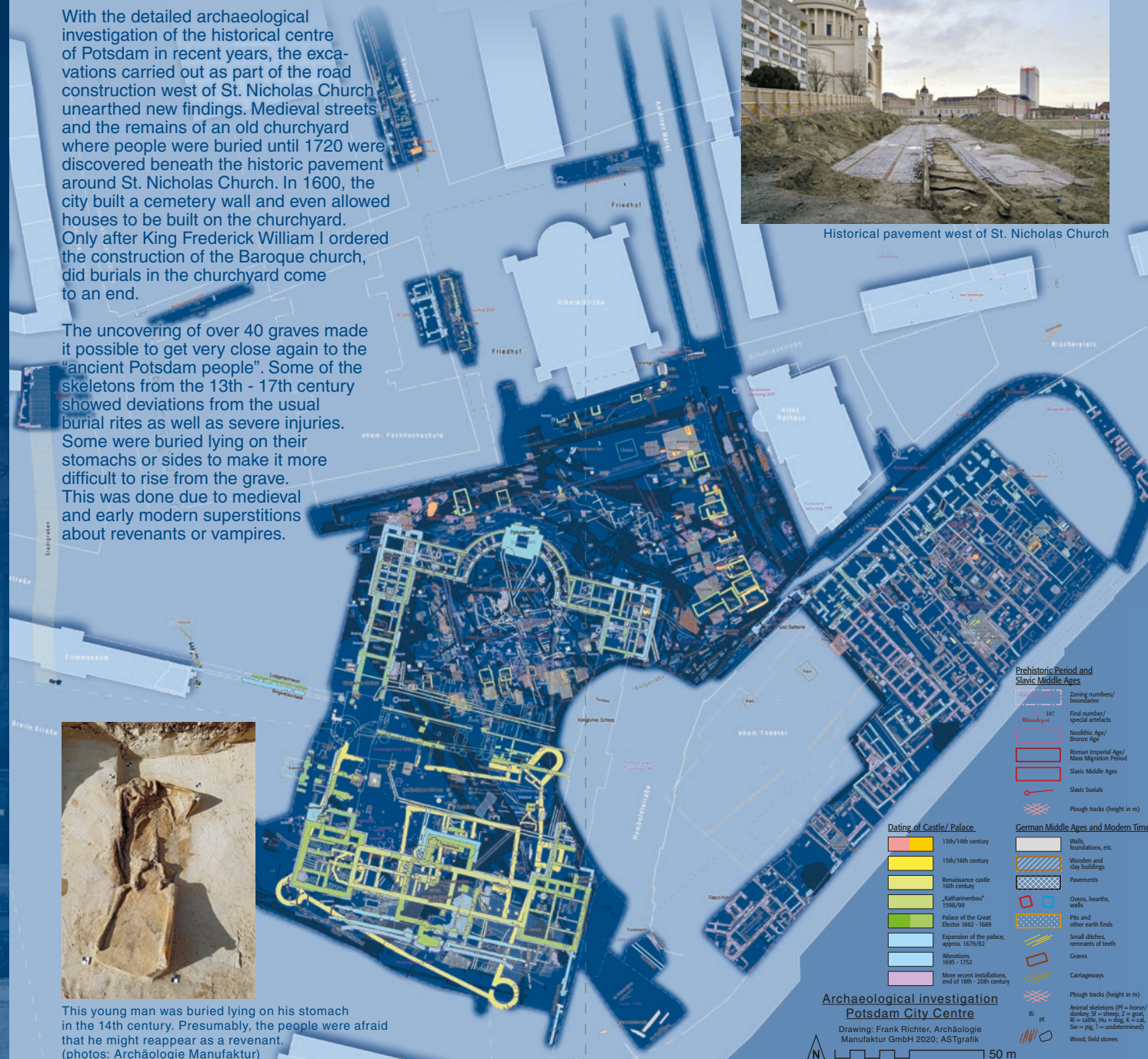

## Synagogue

In the coming years, the federal state government will build a complex suitable for use as a synagogue and community centre on the site of Schloßstrasse 1 in Potsdam. After an intense process spanning more than ten years, a design is now being realized that is accepted, endorsed, and even supported by a large majority of the Jewish population in Potsdam.

The construction of the synagogue is a symbol of the fact that Jewish life in Potsdam will be present where it belongs: at a prominent place, in a Jewish, sacred building with which people can identify. Jewish life will once again be able to flourish in the heart of the city.

The synagogue will be an open building. A café and a room for events are planned for the ground floor, while the religious centre will be located on the 1st floor. The synagogue room with a ceiling height of about nine metres is also located here. The other floors will accommodate community rooms and offices. A terrace will be created on the roof area, which can be used for open-air community festivities. On the façade, a two-story round arch marks the main entrance. The synagogue room, which protrudes from the façade, is accentuated by seven round-arched windows, which offer a view of the city as if from a balcony.

Construction will start in autumn 2021 and completion is expected in 2023. The Brandenburg State Enterprise for Real Estate and Construction will be responsible for the execution of the construction. In the future, the centre will be open to all Jewish communities in Potsdam for religious services, religious celebrations and gatherings and cultural events as well as for social counselling services and training sessions.



Visualisation of the new synagogue

## Block IV – Landmark Building Concept

In August 2020, the city council decided on the award procedure for the properties in Block IV. The call for tender followed in December, and interested bidders were able to apply with a utilization concept. Similar to the area south of the former University of Applied Sciences (Block III), Potsdam has a concept for the urban and architectural development. So-called building passports formulate specifications for each individual lot, on which a house once stood in the past. Both use and design have to adhere to these specifications.

The block is divided into four "construction" lots. The lot directly west of the Education Forum Potsdam will be developed by the municipal housing association ProPotsdam GmbH. Institutions located in the Education Forum will get more space there, e.g. the children's and youth library. Flats with affordable rents on the upper floors will complement the commercial use on the ground floors of Friedrich Ebert Strasse. A building with student accommodation will be built east of the Education Forum.

In 2021, two new owners will be found for properties along Erika Wolf Strasse (former Schwertfegerstrasse) who will then complete the block with its small-scale structure. In selecting the new owners, special attention will be paid to creating "affordable" housing space. The ground floor zones are to be used for typical inner-city facilities that continue to fill Potsdam's city centre with public life.

Architectural competitions will deliver convincing designs for the new construction, which are expected to be completed and presented to the public at the end of 2021. The structural implementation will start in 2023.



Block IV, urban development design (Planergemeinschaft/Redlich) 20 m

# Potsdam City Centre





Dear Residents of Potsdam,  
Dear Visitors and Guests,

Do you feel the same? We have already gotten used to the unobstructed view of St. Nicholas Church from Friedrich Ebert Strasse. In 2021, however, this fascinating view will disappear because after intensive years of planning the time of construction has now come. After careful archaeological investigations were completed, civil engineering work on the construction pit already began in September 2020. Flats, artist's workshops and space for retail, restaurants and services will be built on the so-called Block III. I am particularly pleased about the commitment of Potsdam's housing cooperatives to this project.

On the other side of the street, the second "Achteckenhaus" ("Octagonal House") will be completed and the construction work for "Haus Einsiedel" ("Einsiedel House") will begin. With the new construction of the synagogue, this wide empty lot will also be closed. The start of the construction work is scheduled for the autumn of 2021. In 2021, we will begin the tendering procedure for the properties of Block IV. It is already clear that there will be public uses in this area as well. The institutions of the Education Forum have become such an integral part of Potsdam's city centre that they need more space.

2021 will be a significant year for some projects, which were discussed, sometimes quite controversially, over the past months and years. We will hopefully witness the beginning of the construction work for the synagogue and celebrate the start of construction work for the Creative Quarter. Even if these projects are very different, they have one thing in common: We are able to implement them due to the interaction of public, private and civic engagement. I wish all those who are involved in implementing these ambitious projects much success.

And even though I will miss the view of St. Nicholas Church radiating in all directions, I am looking forward all the more to the upcoming topping-out ceremonies and move-ins to the new quarters in Potsdam's city centre.

Sincerely,  
Mike Schubert  
Mayor of Potsdam



Potsdam City Centre  
04/2020 (Falcon Crest)

## Plantation 2nd Stage of Construction

The Plantation – one of Potsdam's three large city squares – has been redesigned in several stages since April 2018: The first construction stage was inaugurated in 2019. Now, not only the pupils of the Max Dortu Primary School but also all visitors can use the Plantation as an inner-city park with its facilities for play and exercise. The children's playgrounds are particularly popular. On warm summer evenings, break dancers, choir singers, fitness and yoga enthusiasts and many others pursue their hobbies. Redevelopment of the southern section began in autumn 2020 after the computer hall could be demolished. The circular trail, which invites exercise or a leisurely walk around the park, will be completed. Inside it, a mini pitch with football goals as well as a streetball facility and a long-jump pitch will be built for school and recreational sports. Ball stop fencing will provide safety. The "Small Plantation" adjoins the area with numerous trees and perennial plants offering a varied view at any time of the year.

The implementation of the winning design by hutterreimann Landschaftsarchitekten (Berlin) of the landscape planning competition held in 2016 will undoubtedly upgrade this square as a green inner-city space. The design combines the historical features of Peter Joseph Lenné with modern elements adapted to the needs of today's users.

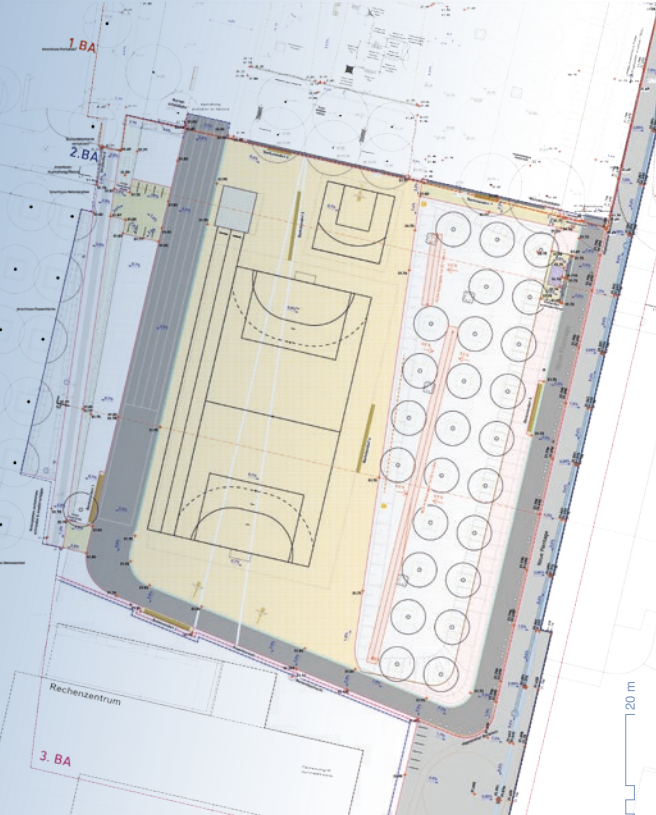

Plantation layout plan, 2nd construction stage  
(hutterreimann Landschaftsarchitektur GmbH)

## Construction Schedule 2021

- Completion of the redesign of the Plantation's southern part (2nd stage of construction) ①
- Reconstruction of Spornstrasse ②
- Start of first construction stage of the Creative Quarter ③
- Erection of the Garrison Church tower ④
- Completion of construction work on Schwertfegerstrasse 9 (landmark façade of "Achteckenhaus" – Octagonal House) ⑤
- New construction on Friedrich Ebert Strasse 123/Schlossstrasse ("Haus Einsiedel" – Einsiedel House) ⑥
- Reconstruction on Block III ⑦
- Start of the construction of the Synagogue ⑧

## From 2022

- Redesign of "Versailer Platz" ⑨
- New construction of the Creative Quarter ⑩
- Reconstruction on Block III ⑦

## From 2023

- Completion of the first stage of construction of the Creative Quarter ③
- Completion of new construction on Block III ⑦
- Final paving of Anna Flügge Strasse and Erika Wolf Strasse ⑩
- Start of building construction on Block IV ⑪

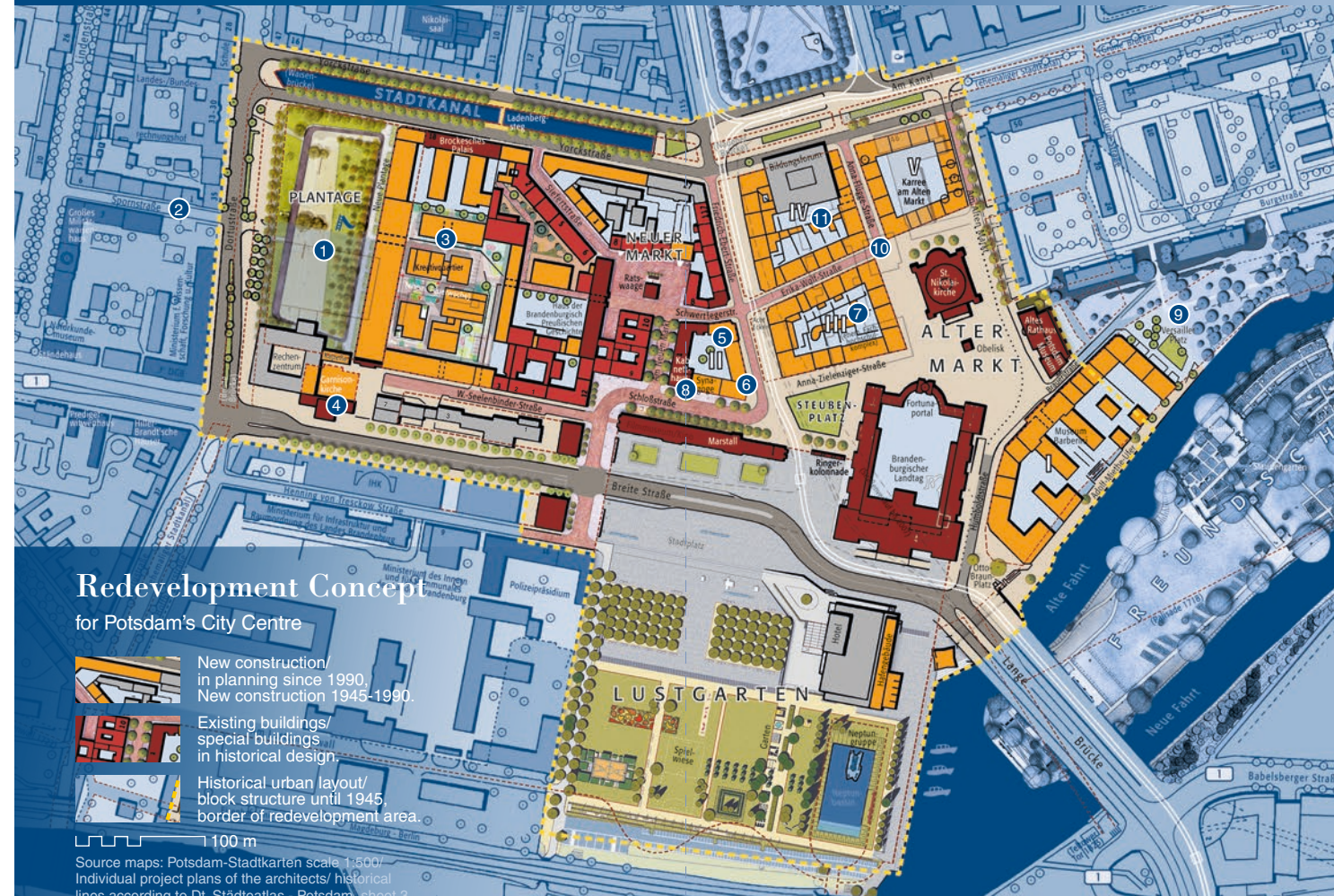

## Redevelopment Concept for Potsdam's City Centre

- New construction/ in planning since 1990. New construction 1945-1990.
- Existing buildings/ special buildings in historical design.
- Historical urban layout/ block structure until 1945, border of redevelopment area.

Source maps: Potsdam-Stadtkarten scale 1:500/  
Individual project plans of the architects/ historical lines according to Dt. Städteatlas - Potsdam, sheet 3.  
Maps/montage/drawings: ASTgrafik  
© 2020 Sanierungsträger Potsdam GmbH

## Creative Quarter in the City Centre

The cultural and creative industries, which have been using the former computer centre in different ways since 2014, are now well established in Potsdam's city centre. A creative quarter is now being built on the adjacent site of the former Feuerwache (Fire Station), which will provide long-term space for both the current users of the computer centre and other creative and cultural professionals from the end of 2023 onwards. At that time, the temporary use permit for the former computer centre will expire. A total of about 15,000 m² of floor space will be created, of which approx. 8,000 m² will be rent-controlled for 20 years.

As part of a call for tender, Glockenweiß GmbH was selected as the best bidder with its construction and usage concept "Village" due to the innovative space and building design. It was the basis for further developments in a subsequent workshop and dialogue process that involved experts and representatives of the cultural and creative industries. The architects' office Michels (Berlin) succeeded in an architectural competition. The winning design added further details to the individual buildings of the "Village" concept and developed an architecture with variable floor plans for the creative scene.

The concept devises a closed perimeter block development and free-standing buildings inside. The open space and sustainability concept were convincing as well. Spaces for communal use and small rooms create a variety of lounge and meeting places.



Creative Quarter Langer Stall,  
Perspective of the hall (Michels Architekturbüro)

Not only the planned roof and façade greenery strengthen the sustainable development of the quarter but also the use of climate-friendly building materials. The mobility concept is geared to pedestrians and cyclists. On 12th November 2020, the implementation of the urban planning and architectural concept as well as the open space and sustainability concept were confirmed by the selection committee consisting of representatives of future users, urban policy makers, the design council, the city administration and the redevelopment agency.

On this basis, the property purchase agreement is now being concluded and the building application for the first construction phase, "Langer Stall" ("Long Stables"), is being prepared. In addition, the expression of interest procedure for principal tenants, which was launched in autumn 2020, should be completed by mid-2021. This will pave the way for the first construction phase to be ready for occupancy by the end of 2023. In order to enable the implementation of the additional construction phases, an amendment will be made to development plan no. 1 "Neuer Markt/Plantation".



Creative Quarter "Village" top view of the roofs (Michels Architekturbüro)